

**This electronic collection of documents is provided
for the convenience of the user
and is Not a Certified Document –**

**The documents contained herein were originally issued
and sealed by the individuals whose names and license
numbers appear on each page, on the dates appearing
with their signature on that page.**

**This file or an individual page
shall not be considered a certified document.**

6/23/16

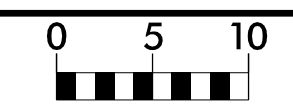

PROJ. REFERENCE NO.	SHEET NO.
49602	X-1

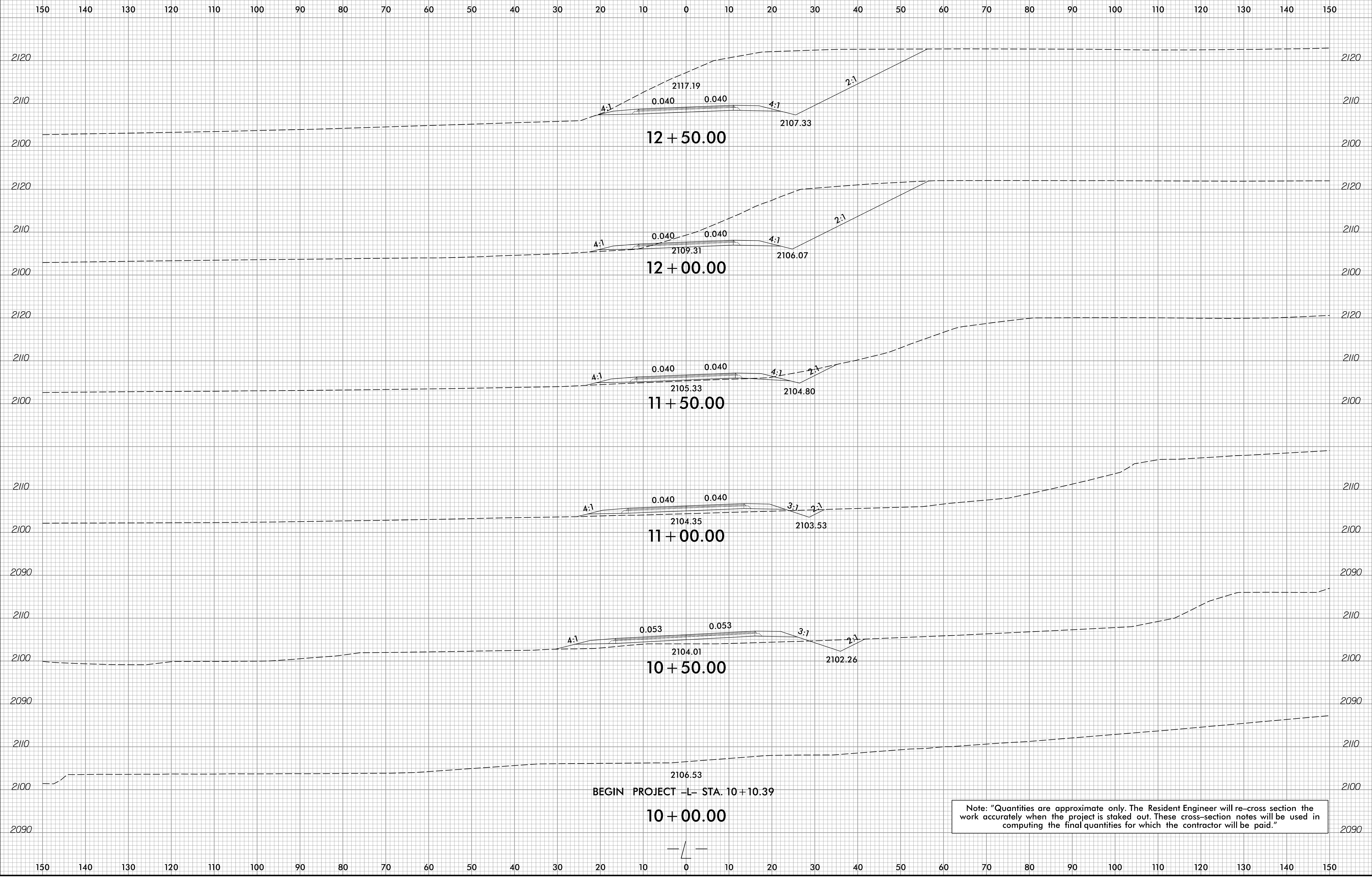

BEGIN PROJECT -L- STA. 10+10.39

Note: "Quantities are approximate only. The Resident Engineer will re-cross section the work accurately when the project is staked out. These cross-section notes will be used in computing the final quantities for which the contractor will be paid."

18-JUN-2016 13:22 Commercial Blvd - Rdwy - xp1.L.dgn

6/23/16

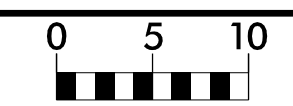

PROJ. REFERENCE NO.	SHEET NO.
49602	X-2

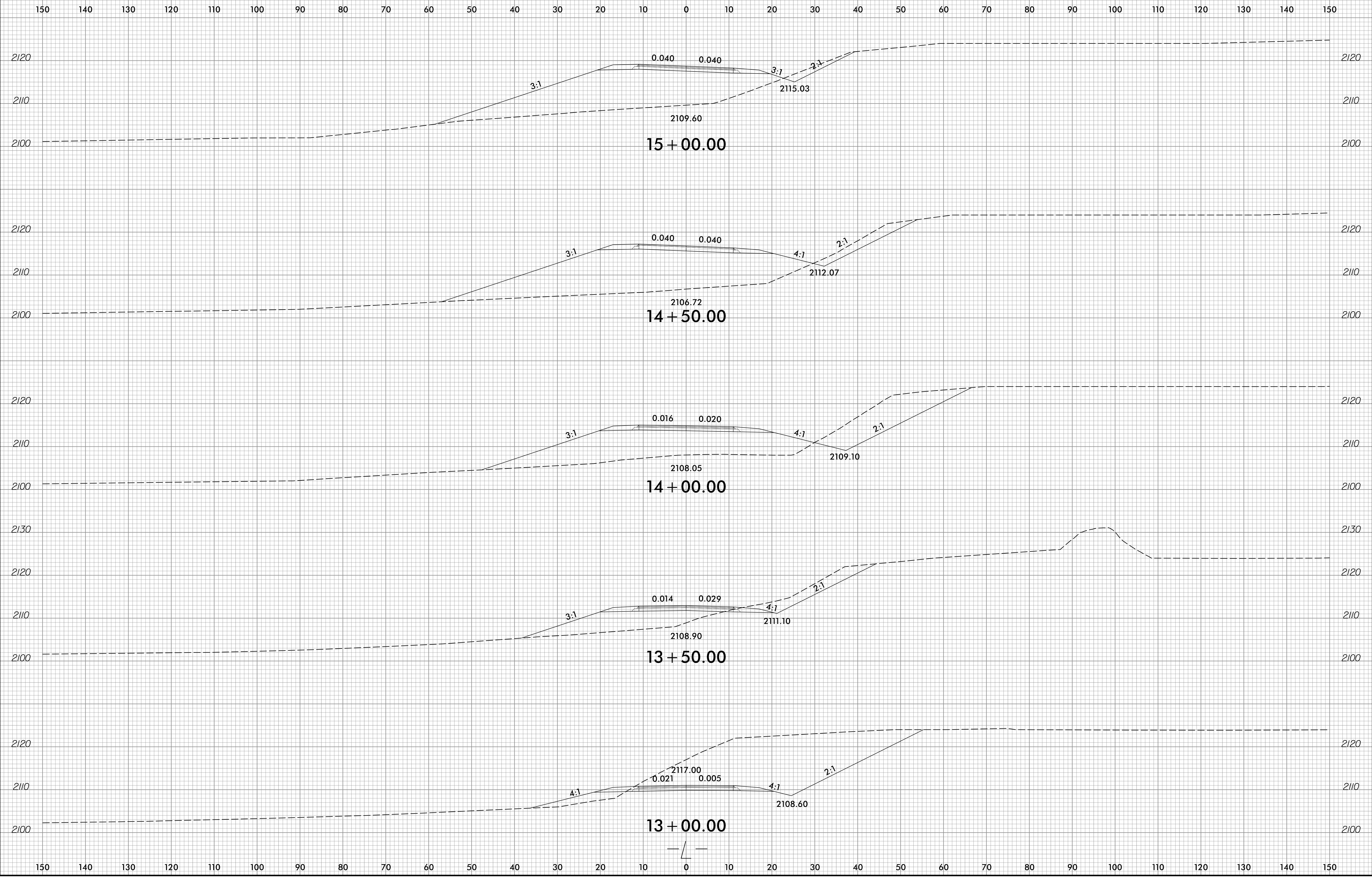

18-JUN-2016 13:22
Commercial Blvd.Rdy_xpl.dgn
spencer.merritt

6/23/16

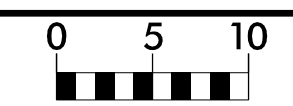

PROJ. REFERENCE NO.	SHEET NO.
49602	X-3

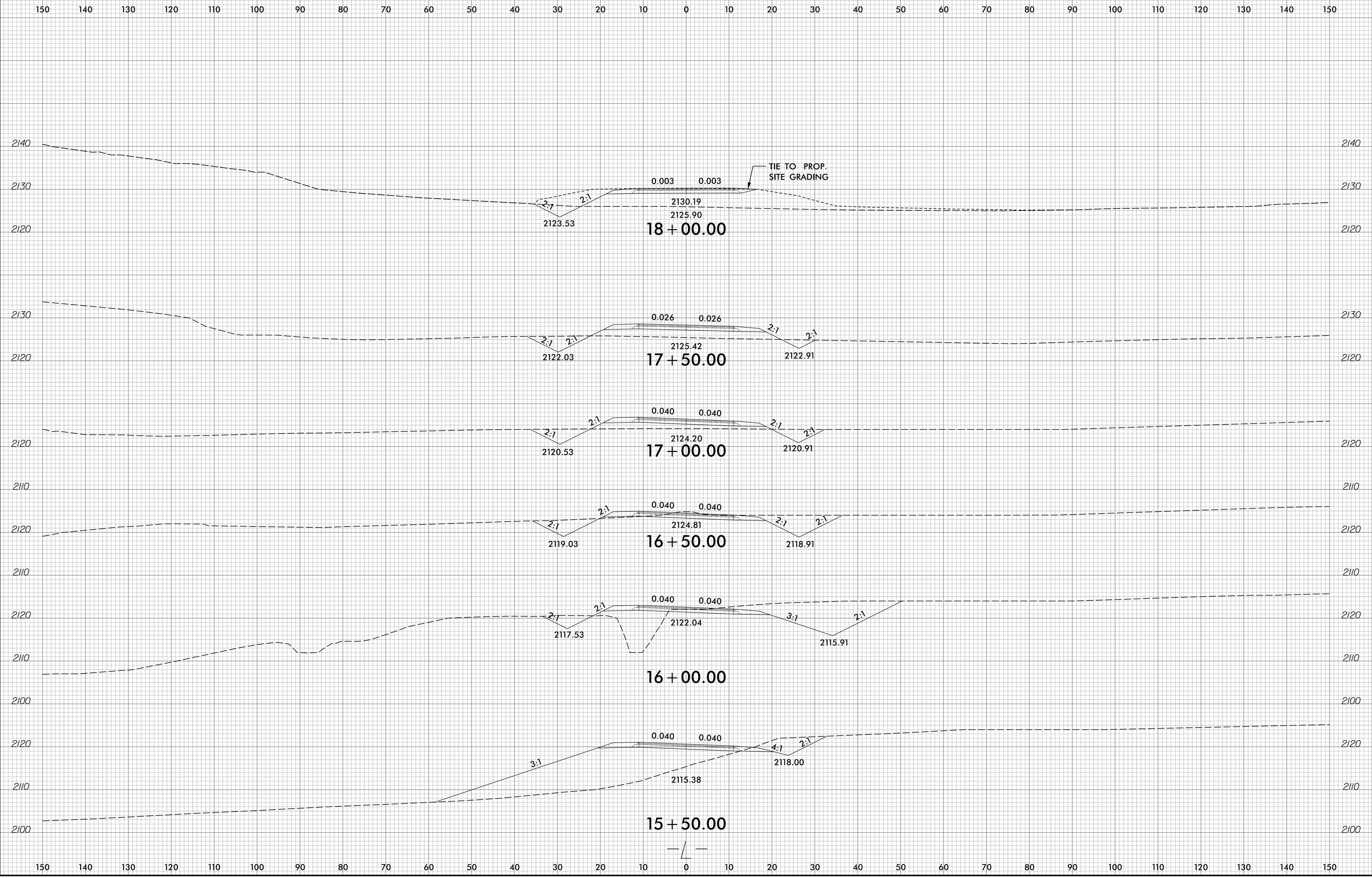

TIE TO PROP. SITE GRADING

18-JUN-2016 13:22
Commercial Blvd.Rdy_xpl.dgn
spencer.meritt

6/23/16

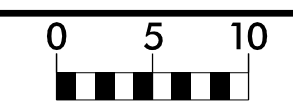

PROJ. REFERENCE NO.	SHEET NO.
49602	X-4

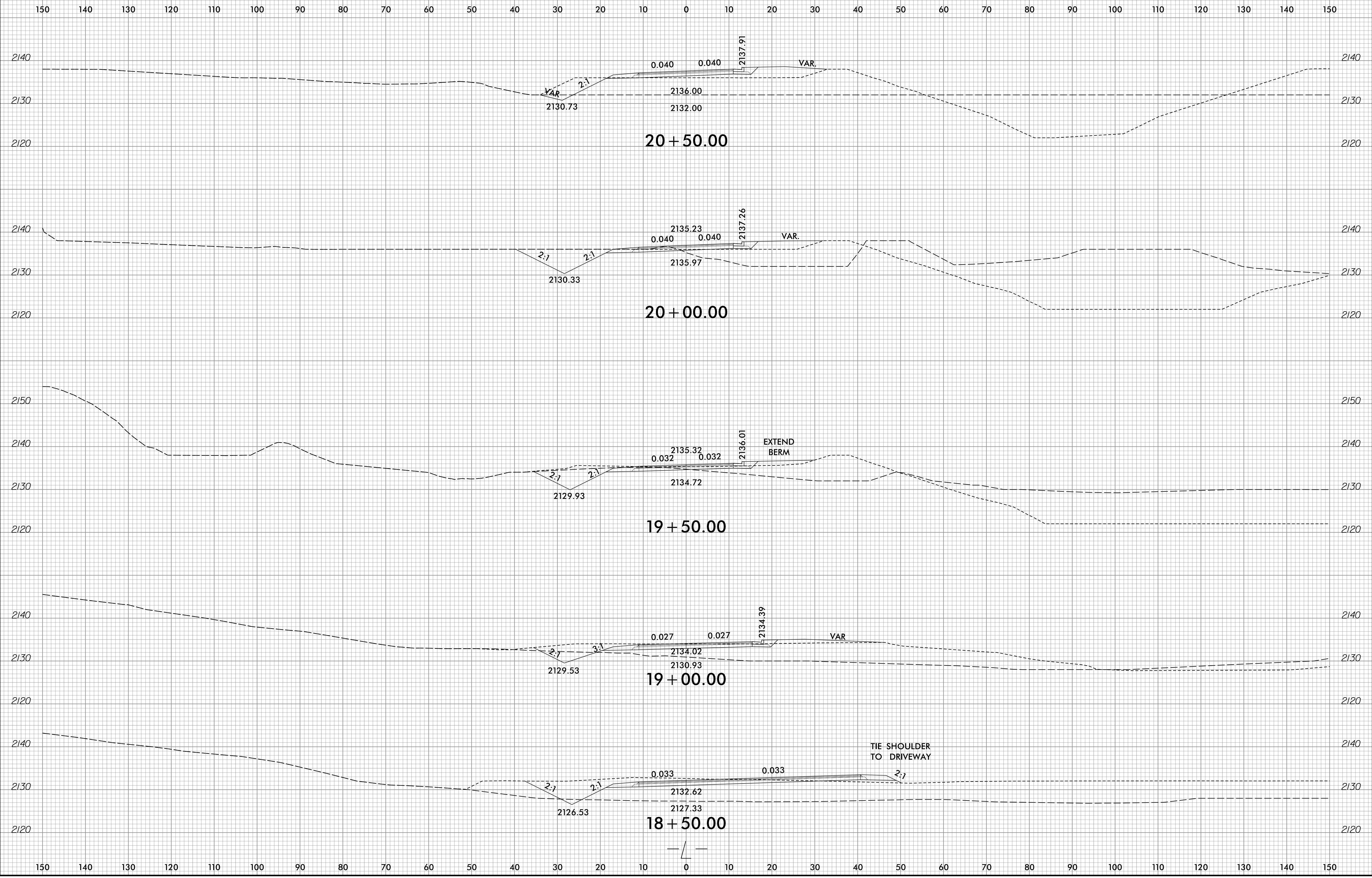

18-JUN-2016 13:22
Commercial Blvd.Rdy_xpl.dgn
Spencer.mbr

6/23/16

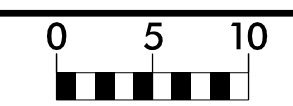

PROJ. REFERENCE NO.	SHEET NO.
49602	X-5

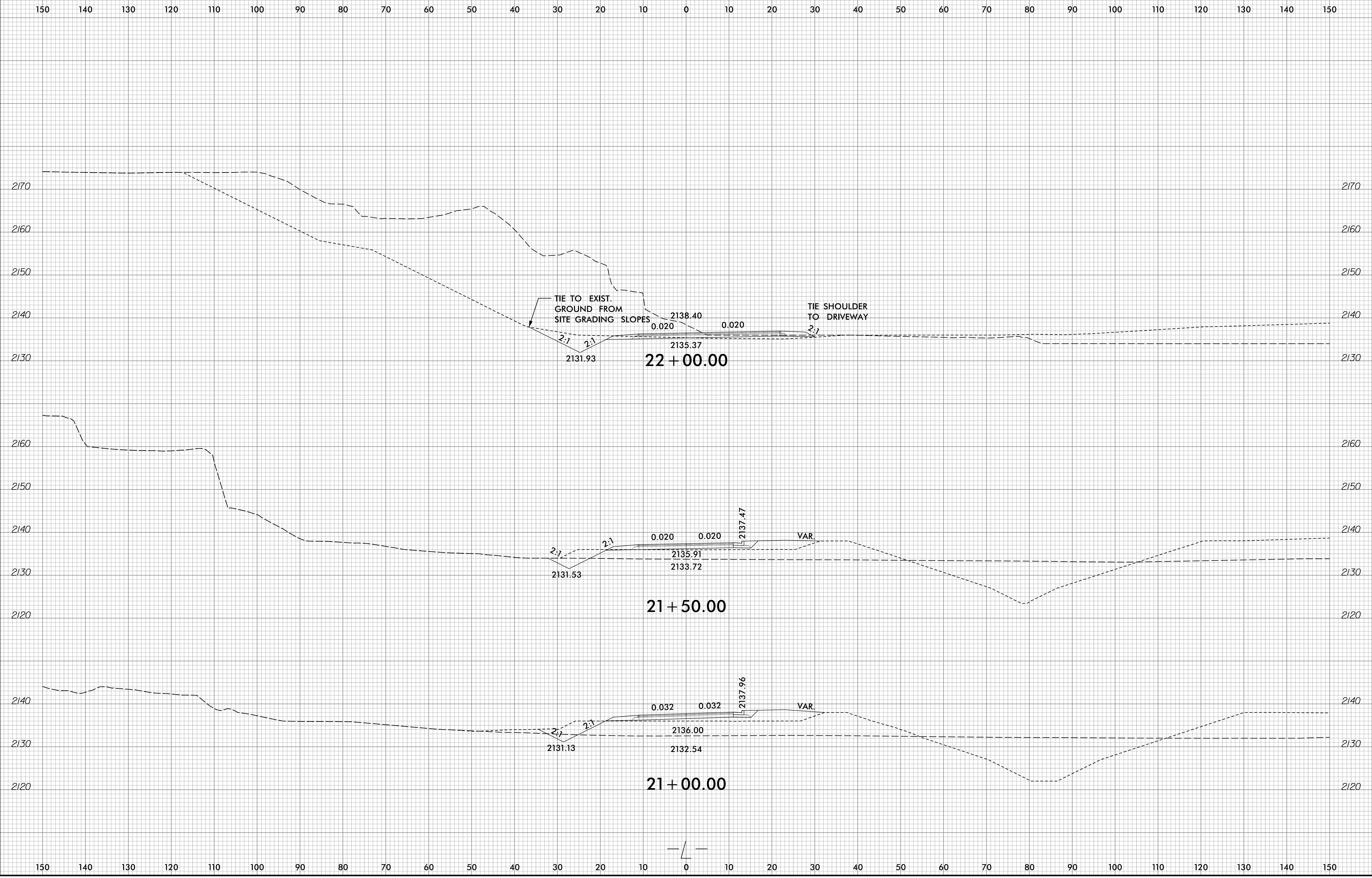

18-JUN-2016 13:22
Commercial Blvd. Rdwy. xpl.dgn
Spencer, Inc.

6/22/16

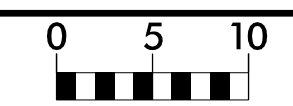

PROJ. REFERENCE NO.	SHEET NO.
49602	X-6

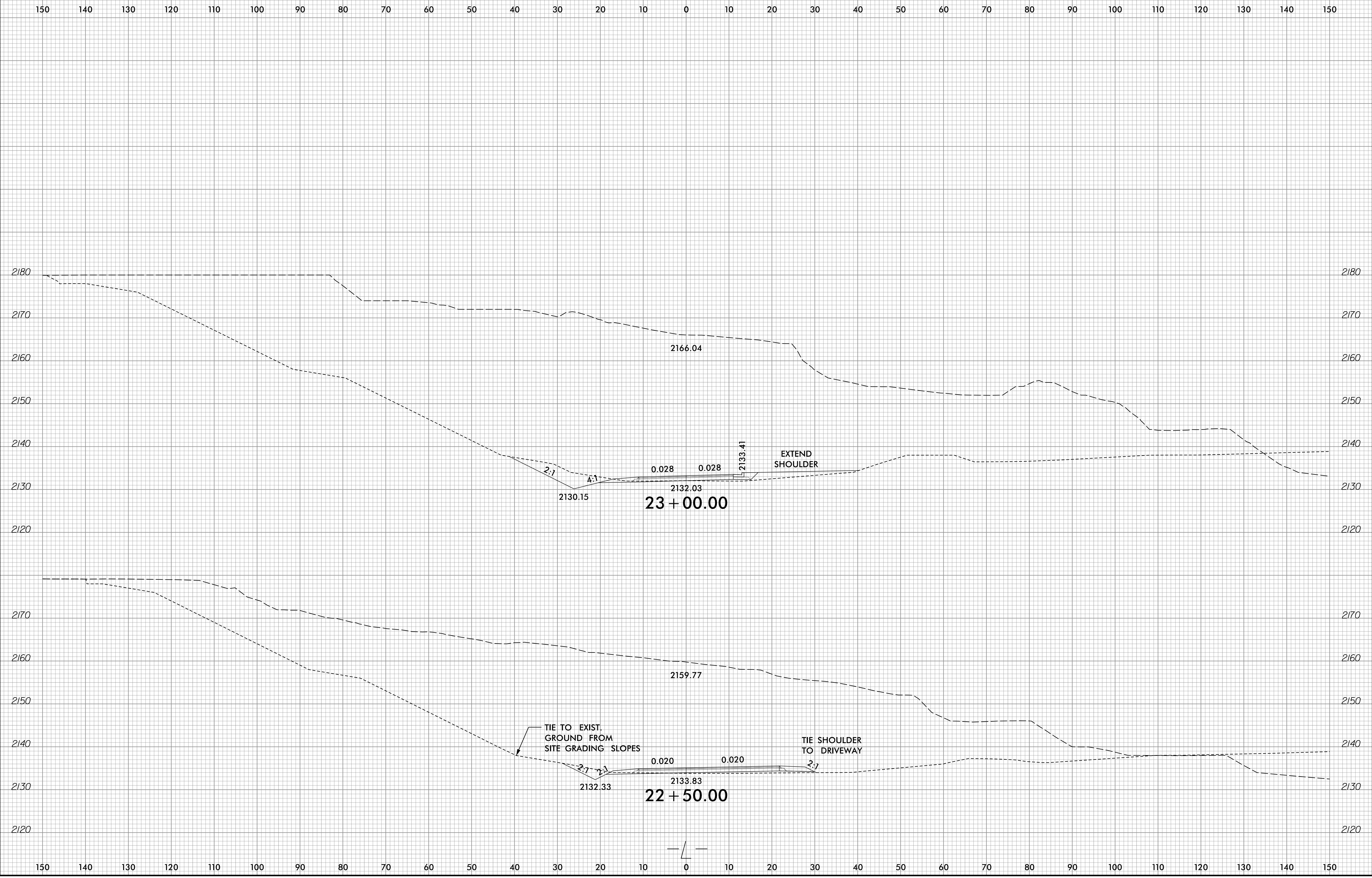

18-JUN-2016 13:22
Commercial Blvd.Rdy_xpl.dgn
spencer.meritt

6/23/16

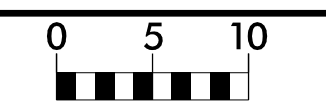

PROJ. REFERENCE NO.	SHEET NO.
49602	X-7

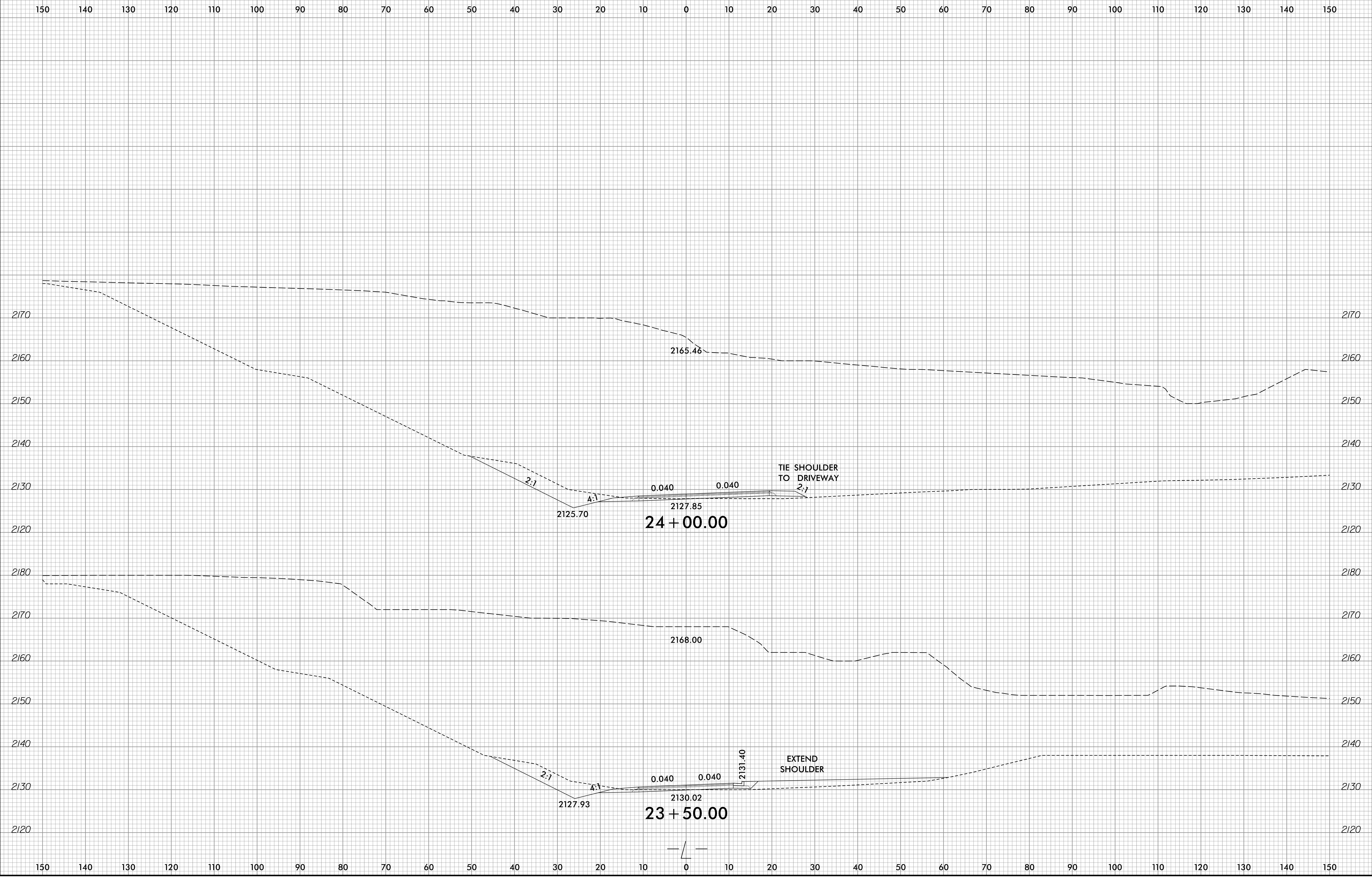

18-JUN-2016 13:22
Commercial Blvd.Rdy_xpl.dgn
spencer.meritt

6/23/16

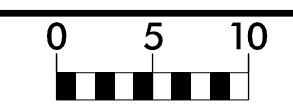

PROJ. REFERENCE NO.	SHEET NO.
49602	X-8

150 140 130 120 110 100 90 80 70 60 50 40 30 20 10 0 10 20 30 40 50 60 70 80 90 100 110 120 130 140 150

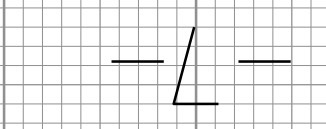
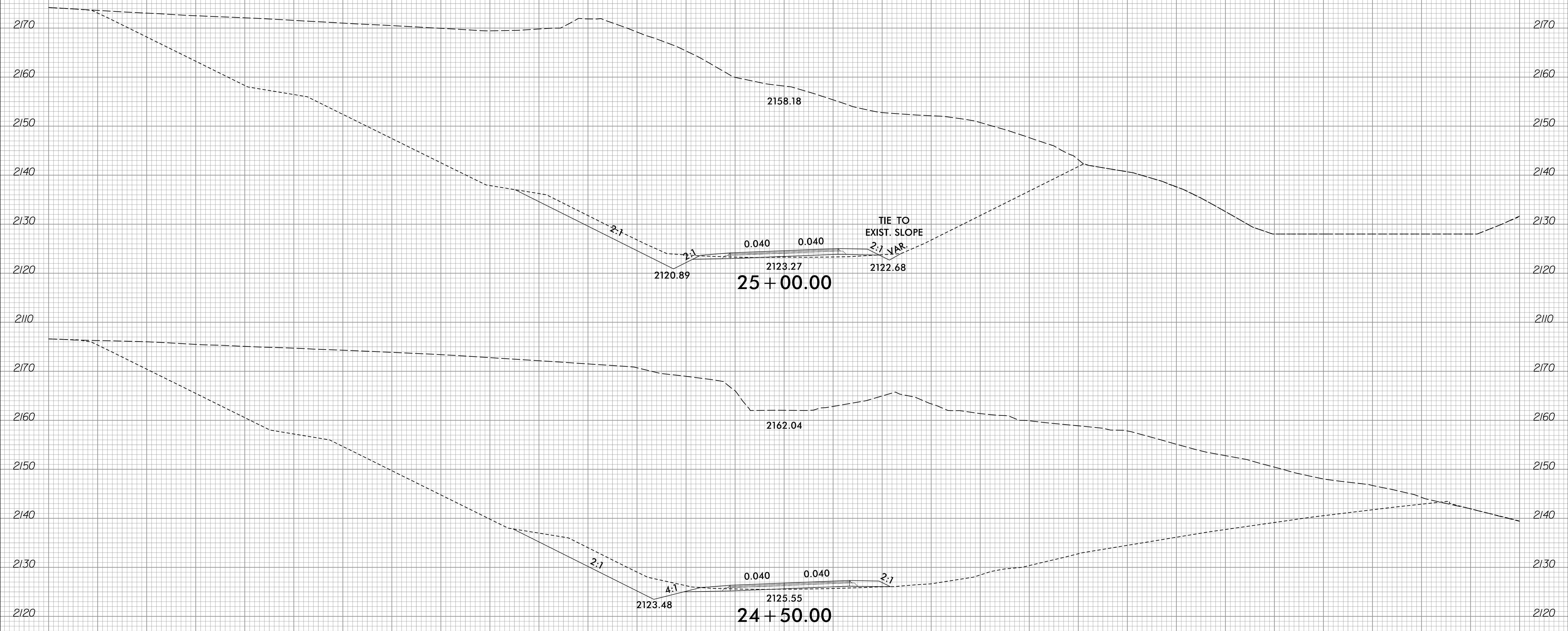

150 140 130 120 110 100 90 80 70 60 50 40 30 20 10 0 10 20 30 40 50 60 70 80 90 100 110 120 130 140 150

18-JUN-2013 13:22
Commercial Blvd. Pdy. xpl.dgn
spencer.meritt

6/23/16

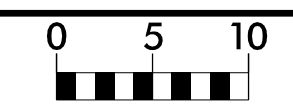

PROJ. REFERENCE NO.	SHEET NO.
49602	X-9

150 140 130 120 110 100 90 80 70 60 50 40 30 20 10 0 10 20 30 40 50 60 70 80 90 100 110 120 130 140 150

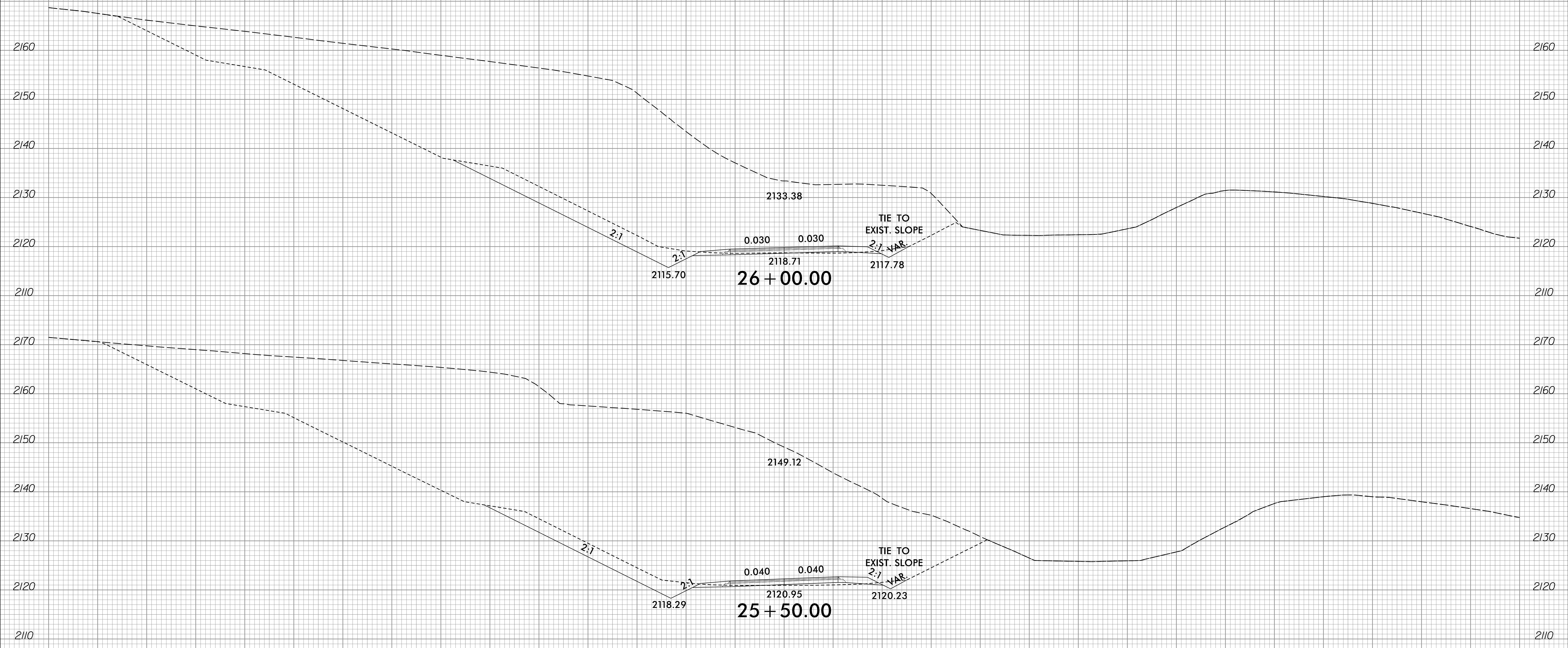

18-JUN-2013 13:22
Commercial Blvd., Rd., xpl., L.dgn
SPENCER INCORPORATED

150 140 130 120 110 100 90 80 70 60 50 40 30 20 10 0 10 20 30 40 50 60 70 80 90 100 110 120 130 140 150

6/23/16

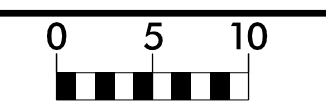

PROJ. REFERENCE NO.	SHEET NO.
49602	X-10

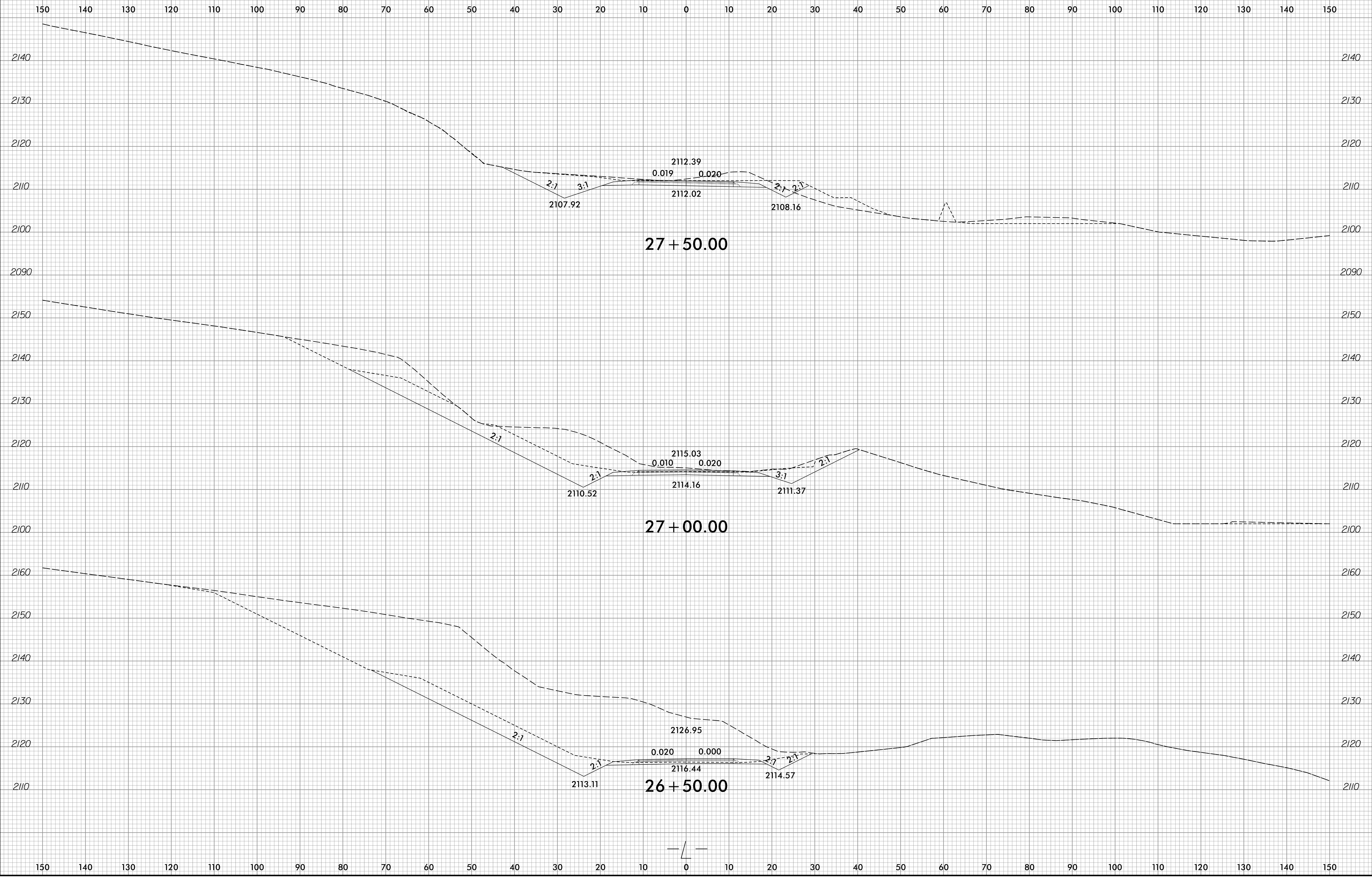

18-JUN-2021 13:22
Commercial Blvd., Rd., xpl., L.dgn
Spencer, Inc.

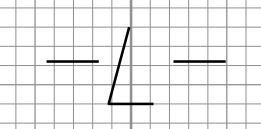

6/23/16

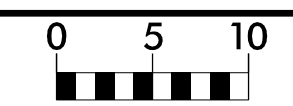

PROJ. REFERENCE NO.	SHEET NO.
49602	X-11

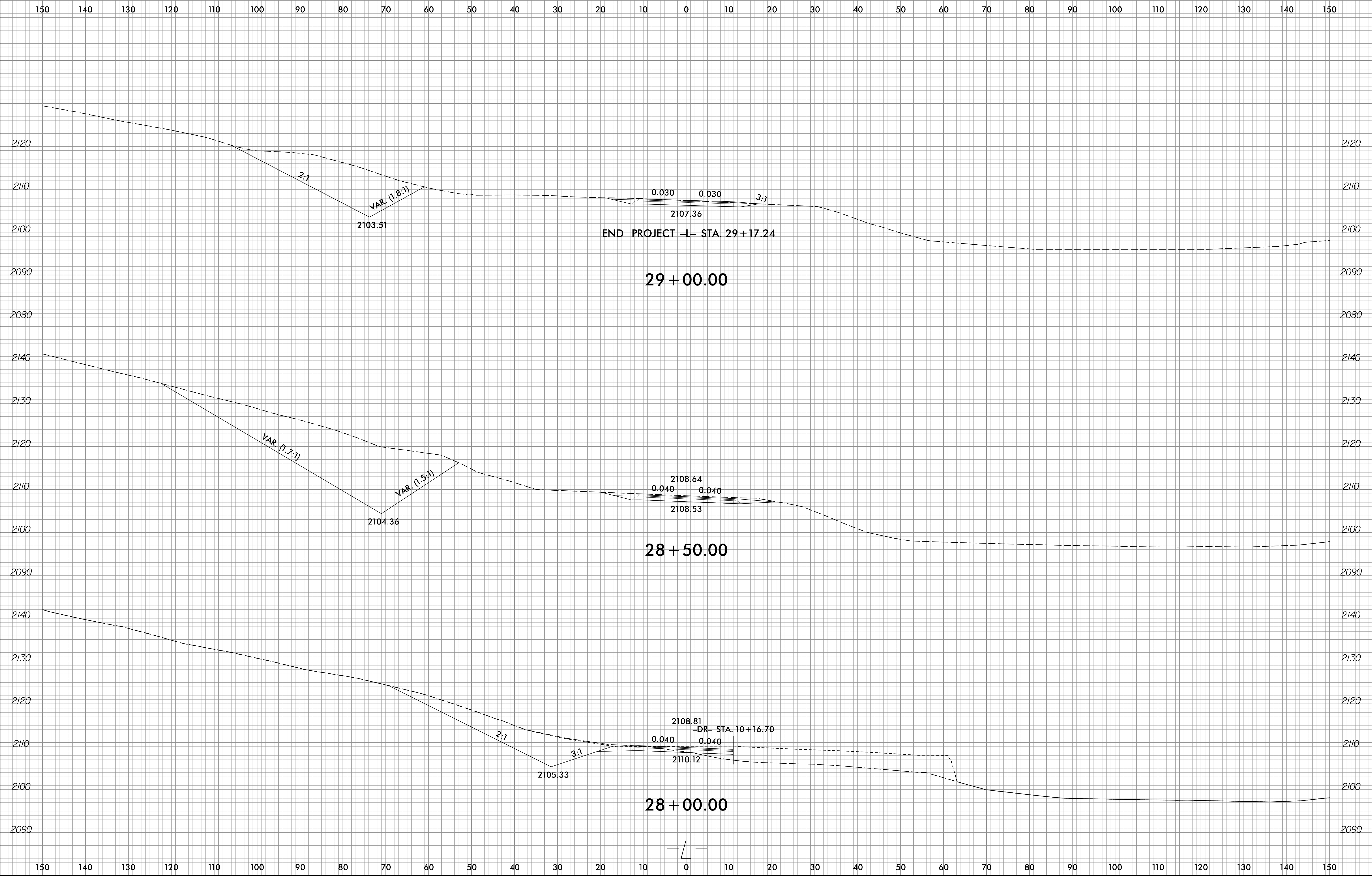

21-JUN-2016 12:09
Commercial Blvd.Rdy_xpl.dgn
spencer.merritt

6/23/16

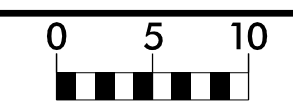

PROJ. REFERENCE NO.	SHEET NO.
49602	X-12

150 140 130 120 110 100 90 80 70 60 50 40 30 20 10 0 10 20 30 40 50 60 70 80 90 100 110 120 130 140 150

END CONSTRUCTION -L- STA. 30+25.00

REMOVAL OF EXIST.
PAVEMENT OUTSIDE
OF EOT FROM
EXIST. CUL-DE-SAC.
GRADE TO DRAIN.

REMOVAL OF EXIST.
PAVEMENT OUTSIDE
OF EOT FROM
EXIST. CUL-DE-SAC.
GRADE TO DRAIN.

2106.82

29 + 50.00

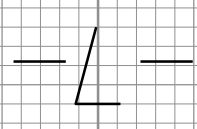

2110
2100
2090

2110
2100
2090

150 140 130 120 110 100 90 80 70 60 50 40 30 20 10 0 10 20 30 40 50 60 70 80 90 100 110 120 130 140 150

18-JUN-2016 13:22
Commercial Blvd.Rdy_xpl.dgn
spencer.meritt

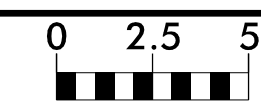

PROJ. REFERENCE NO.	SHEET NO.
49602	X-13

75 70 65 60 55 50 45 40 35 30 25 20 15 10 5 0 5 10 15 20 25 30 35 40 45 50 55 60 65 70 75

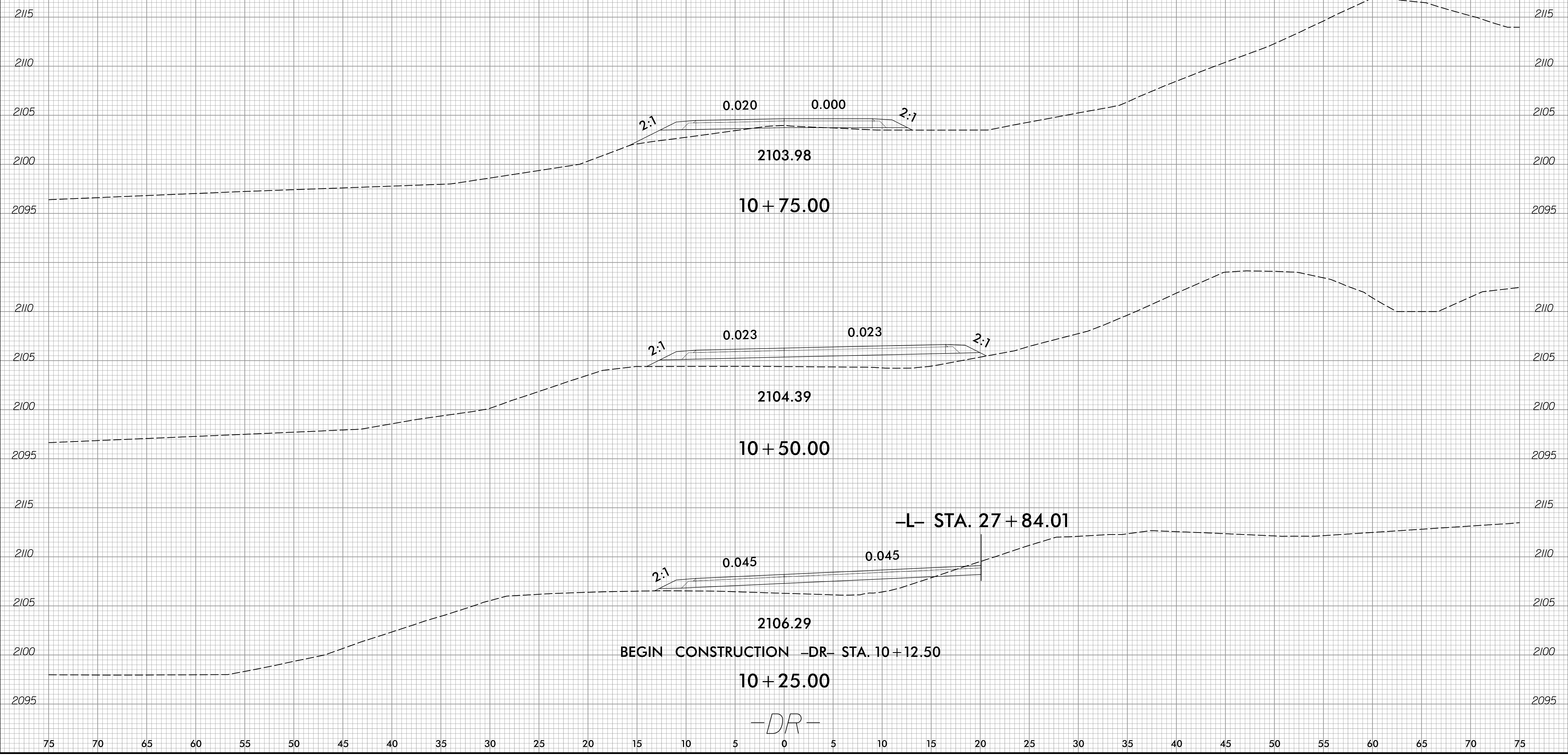

6/23/16

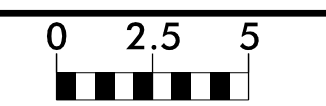

PROJ. REFERENCE NO.	SHEET NO.
49602	X-14

75 70 65 60 55 50 45 40 35 30 25 20 15 10 5 0 5 10 15 20 25 30 35 40 45 50 55 60 65 70 75

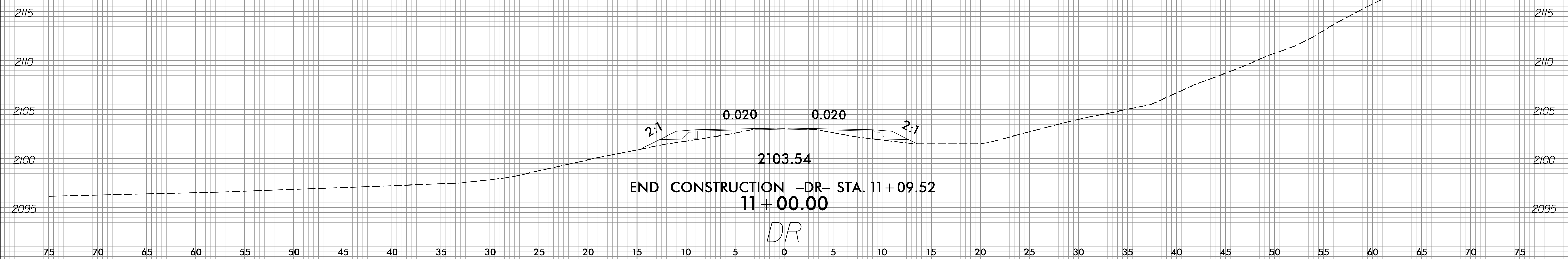

18-JUN-2016 13:22
Commercial Blvd. Rdwy. xp1.DR.dgn
Spencer, Inc.